



# rental guide 2021

---





# welcome

---

The Center for the Arts is the premier visual and performing arts venue on the Western Slope. Its iconic modern architecture, 31,000 square feet of multi-use spaces, and prime location in downtown Crested Butte make the Center an ideal location for all kinds of events, from classes and meetings to retreats, conferences, performances, celebrations, and more.

The Center is LEED-certified and features an efficient HVAC system to keep rooms at the perfect temperature. High-tech A/V systems are built into nearly every space in the building, and the Steddy Theater is acoustically tuned for any type of music or performance. And the building is fully ADA accessible, with an elevator that accesses all three floors.

No matter whether your event is large or small, our team of event planners is here to help you make your vision a reality! Contact us at [info@crestedbuttearts.org](mailto:info@crestedbuttearts.org) to get started.





# the center

floor 1

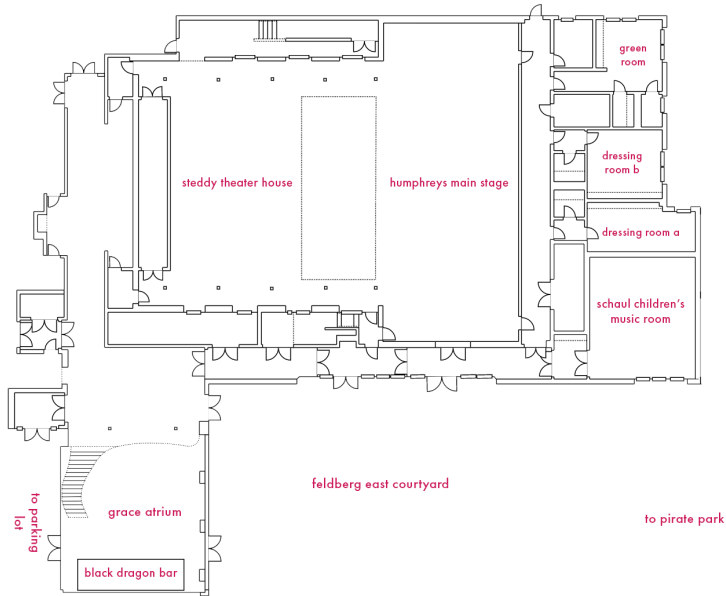

floor 2

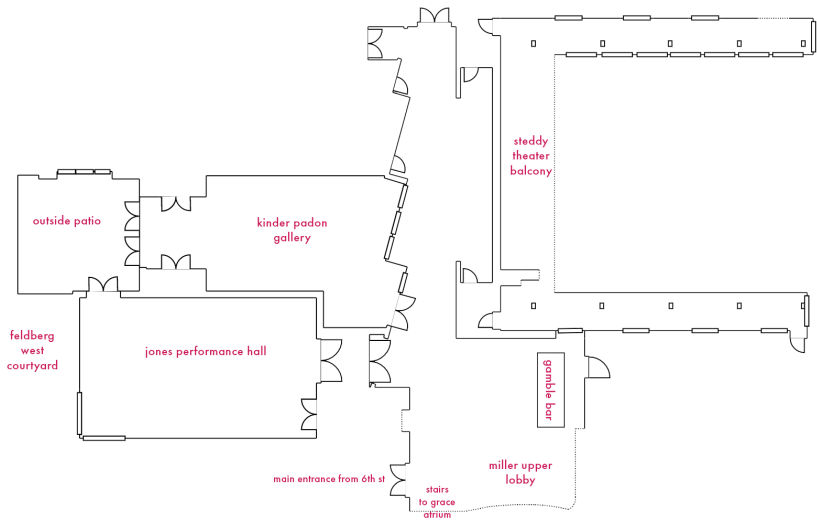

floor 3

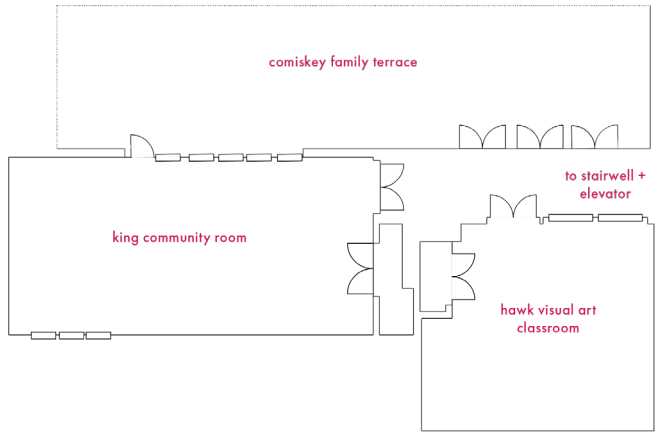





# king community room



## info

<b>square footage</b>	837 sq. ft.
<b>max. capacity</b>	49 people
<b>a/v amenities</b>	75" flatscreen TV with HDMI input Audio system with aux input
<b>pair with these spaces</b>	Comiskey Family Terrace Hawk Visual Art Classroom

<b>other amenities</b>	Mini fridge Sink 16' counter space
<b>best uses</b>	Meetings Classes Workshops Small parties

## layouts

theater style: 48

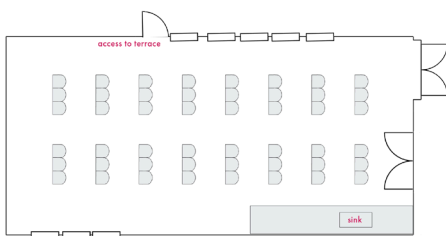

classroom style: 36

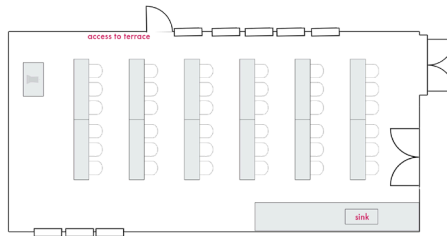

meeting style: 21

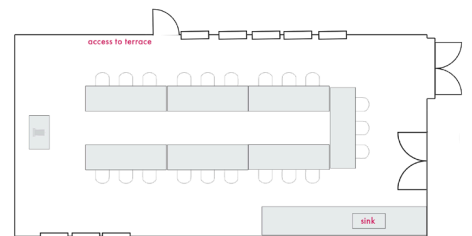





# comiskey family terrace



info	square footage	1,048 sq. ft.	best uses	Parties Celebrations
	max. capacity	49 people		
	a/v amenities	none		
	pair with these spaces	Hawk Visual Arts Classroom King Community Room		

## layouts

cocktail party: 49

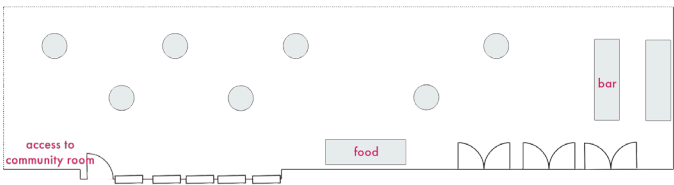

seated dinner: 49

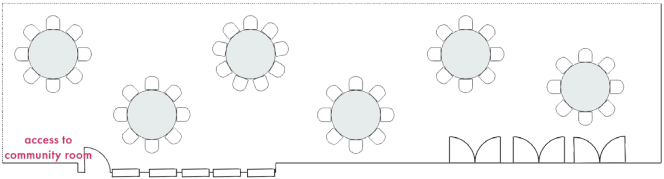

wedding ceremony: 48

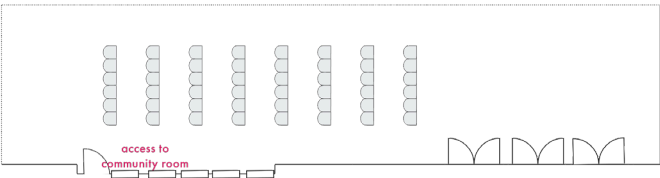



# hawk visual art classroom



info	square footage	581 sq. ft.	other amenities	Sink
	max. capacity	39 people		13' counter space
	a/v amenities	48" flatscreen TV with HDMI input Audio via TV	best uses	Meetings
	pair with these spaces	Comiskey Family Terrace King Community Room		Classes Workshops

## layouts

theater style: 36

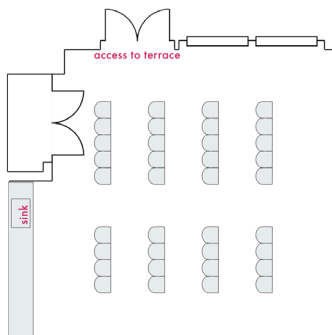

classroom style: 27

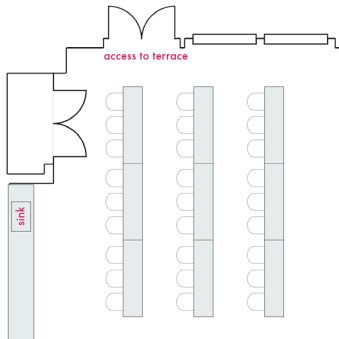

meeting style: 12

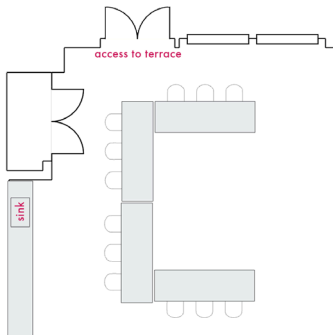



# jones performance hall



## info

<b>square footage</b>	1,041 sq. ft.
<b>max. capacity</b>	53 people
<b>a/v amenities</b>	48" flatscreen TV with HDMI input Audio system with aux input Stage lighting grid
<b>pair with these spaces</b>	Miller Upper Lobby Kinder Padon Gallery Feldberg West Courtyard

<b>other amenities</b>	Forever Marley floors 8' tall mirrors 28' wall-mounted barre Aerial rigging
<b>best uses</b>	Dance & fitness classes Small performances

## layouts

theater style: 50

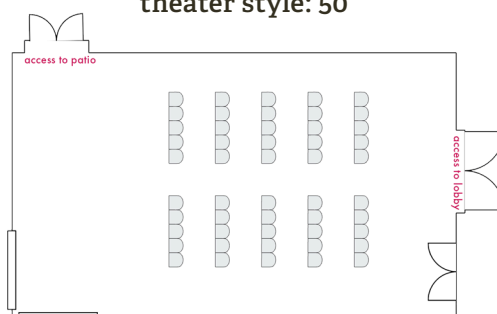

fitness class: 24

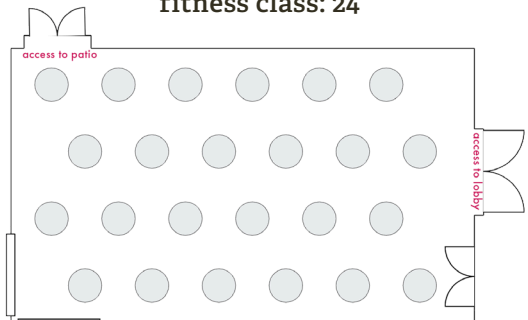



C E N T E R

# schaul children's music room



## info

**square footage** 665 sq. ft.

**max. capacity** 34 people

**a/v amenities** 48" flatscreen TV with HDMI input  
Audio system with aux input  
Stage lighting grid  
BOH clear-com paging system

**pair with this space** Steddy Theater

**other amenities** Forever Marley floors  
8' tall mirrors  
4- 5' freestanding barres

**best uses** Dance & fitness classes  
Small performances

## layouts

theater style: 30

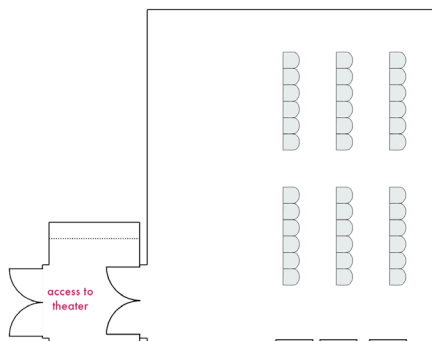

fitness class: 18

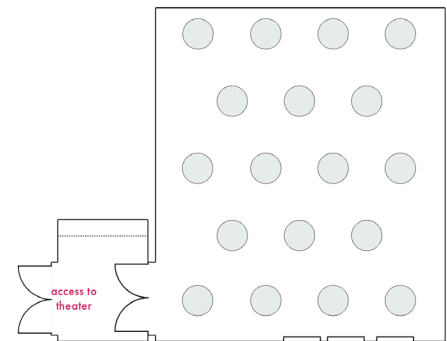



# kinder padon gallery



## info

<b>square footage</b>	901 sq. ft.	<b>other amenities</b>	8' plywood wall backing Adjustable trac lighting
<b>max. capacity</b>	31 people	<b>best uses</b>	Parties Receptions
<b>a/v amenities</b>	Audio system with aux input		
<b>pair with these spaces</b>	Miller Upper Lobby Feldberg West Courtyard Jones Performance Hall		

## layouts

cocktail party: 31

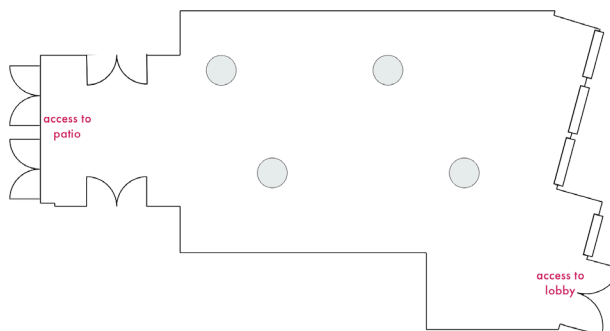



# miller upper lobby



## info

<b>square footage</b>	1,771 sq. ft.	<b>pair with these spaces</b>	Kinder Padon Gallery Feldberg West Courtyard Jones Performance Hall Steddy Theater
<b>max. capacity</b>	159 people	<b>other amenities</b>	The Gamble Bar
<b>a/v amenities</b>	Audio system with aux input 48" flat screen TV	<b>best uses</b>	Parties Receptions

## layouts

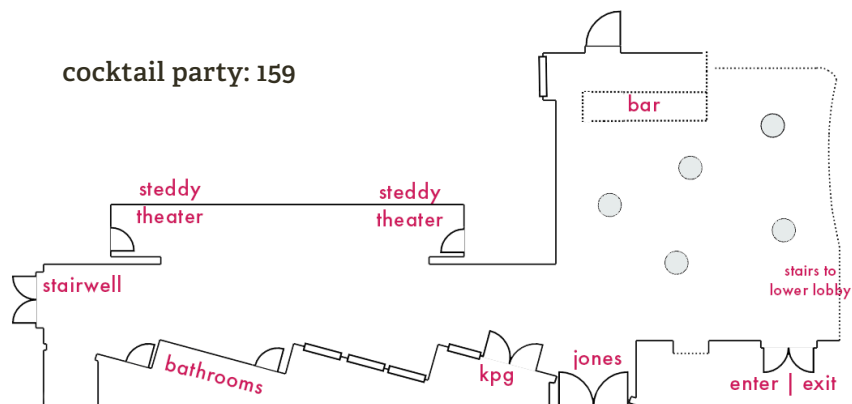



# grace atrium



## info

<b>square footage</b>	2,564 sq. ft.	<b>pair with these spaces</b>	Miller Upper Lobby Steddy Theater Feldberg East Courtyard
<b>max. capacity</b>	319 people	<b>other amenities</b>	The Black Dragon Bar
<b>a/v amenities</b>	Audio system with aux input 2- 48" flat screen TVs Video wall "jumbotron" Paging mic	<b>best uses</b>	Parties Receptions

## layouts

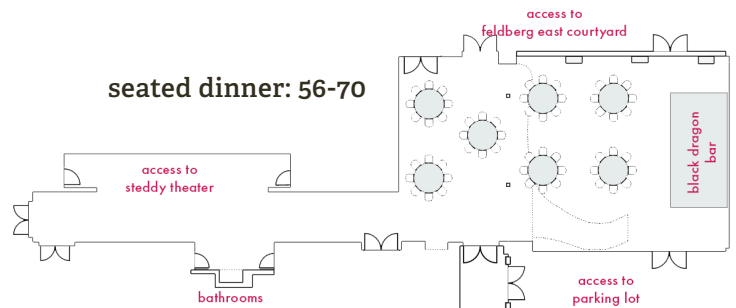



# feldberg east courtyard



## info

square footage	3,572 sq. ft.	best uses	Parties Receptions Dinners Acoustic Performances
max. capacity	319 people		
a/v amenities	None		
pair with these spaces	Grace Atrium Steddy Theater		

## layouts

performance: 319

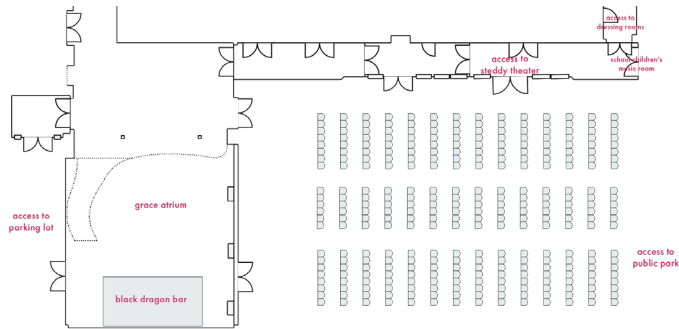

seated dinner: 192-240

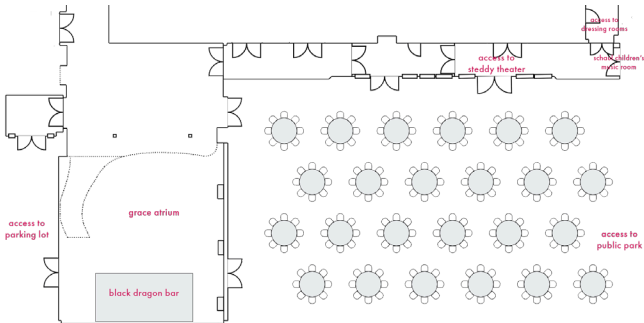

Please note that the Feldberg East Courtyard is an outdoor, gravel space that is not tented or covered to protect against inclement weather, however, you may hire a rental company to set up a tent. Rental of the Grace Atrium is required for use of the courtyard. Only recorded music and speaking at a reasonable level is allowed in the East Courtyard, and all amplified sound must conclude by 8:00 p.m. The Feldberg East Courtyard is adjacent to a public playground and pavilion.





# back of house spaces

## dressling room a

**square footage** 262 sq. ft.

**max. capacity** 14 people

## dressling room b

**square footage** 269 sq. ft.

**max. capacity** 14 people

**amenities** Makeup mirrors with LED lights  
Makeup counters  
Mini fridge + coffee maker  
Adjacent single-stall bathrooms



## green room

**square footage** 295 sq. ft.

**max. capacity** 20 people

**amenities** Washer + dryer  
ADA accessible shower  
Mini fridge, coffee maker, dishwasher  
Sink and countertop area

---

### BOH a/v amenities

Flat screen TV w/ live stage feed  
BOH clear-com paging system

### pair with these spaces

Steddy Theater  
Schaul Children's Music Room

### best uses

Makeup and hair  
Costuming  
Getting Ready  
Performer/Vendor Lounges





# the steady theater



# fully seated performance: 284-305

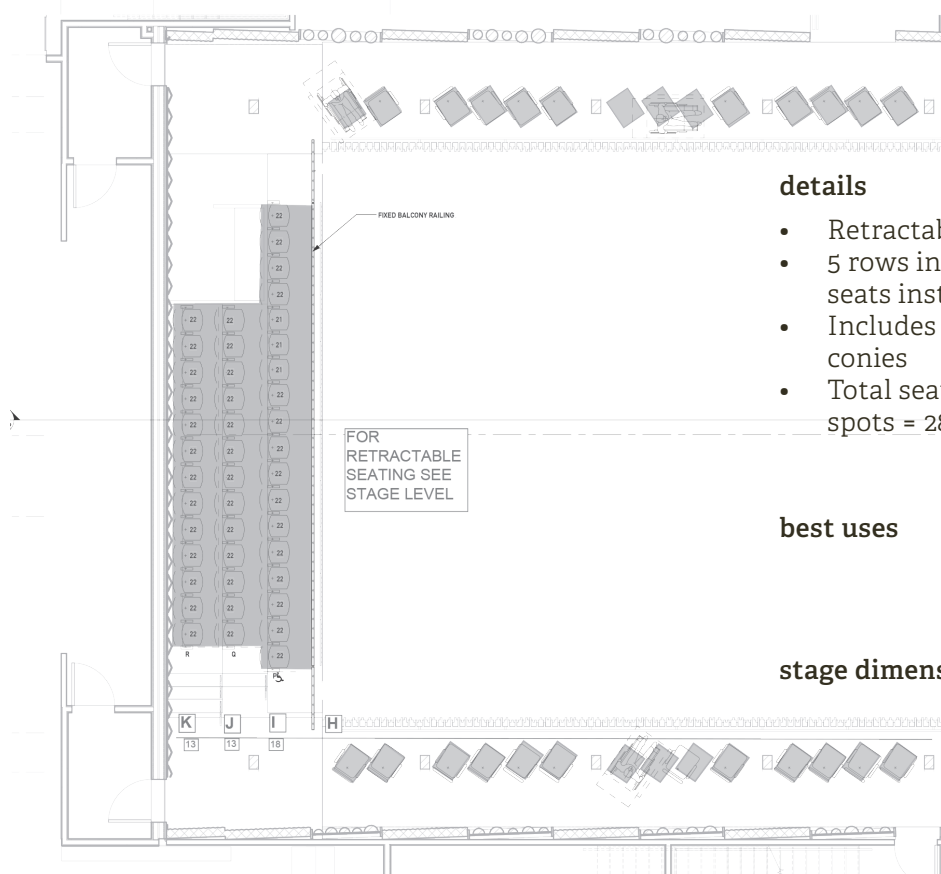
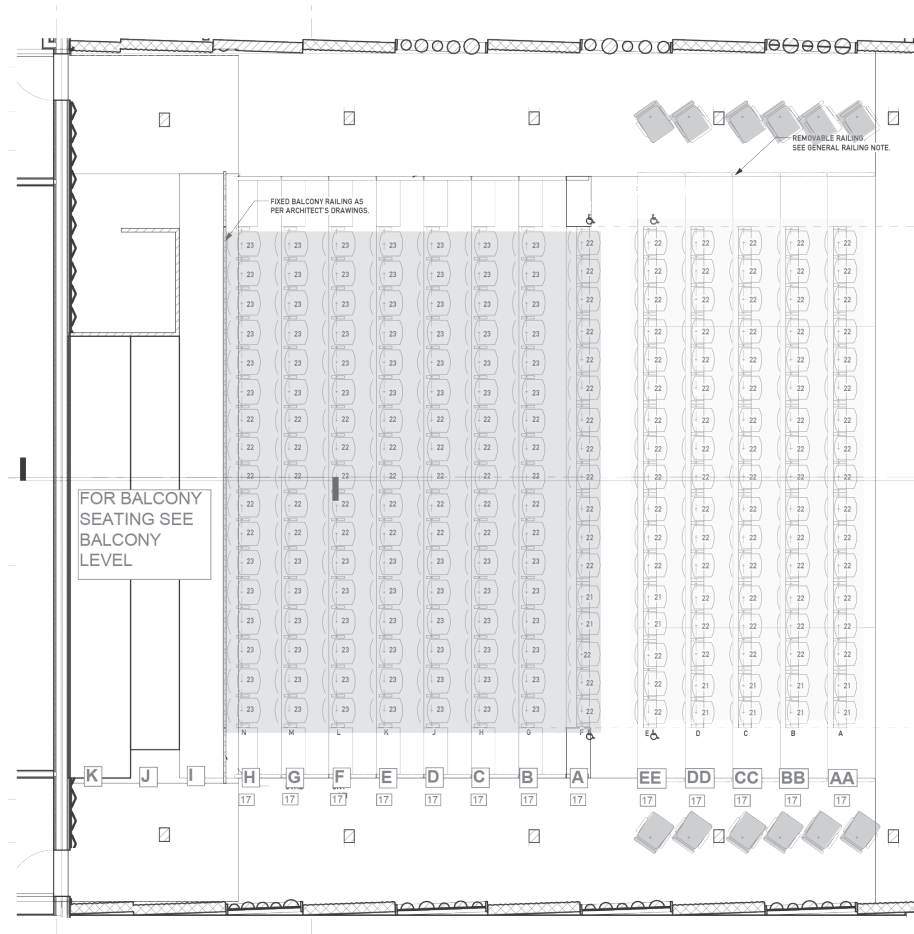

## details

- Retractable seating platform fully extended
- 5 rows in front orchestra pit raked and 85 seats installed
- Includes 28 moveable seats in the side balconies
- Total seating capacity with 4 wheelchair spots = 284 (increases with 0-3 wheelchairs)

## best uses

Classical music performance  
Film screening  
Live theatre  
Lecture/panel discussion

**stage dimensions** 28' x 24' x 30'

# partially seated with dance floor: 350

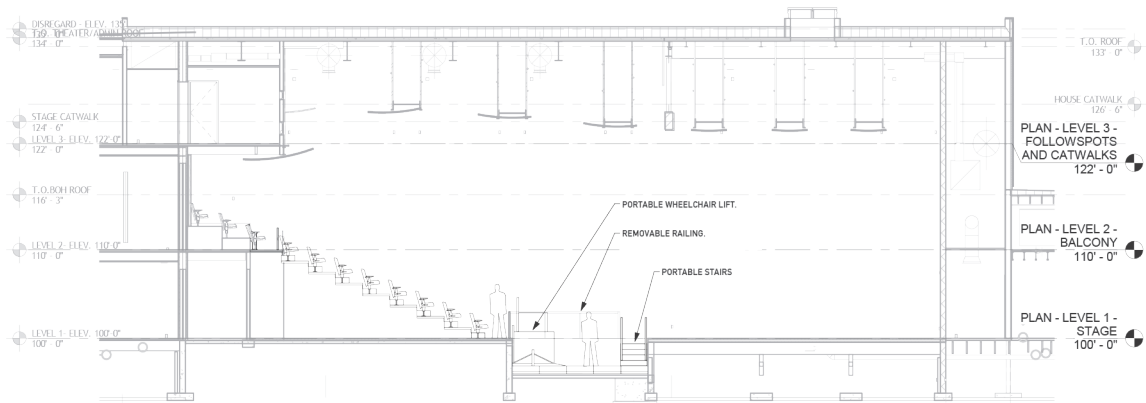
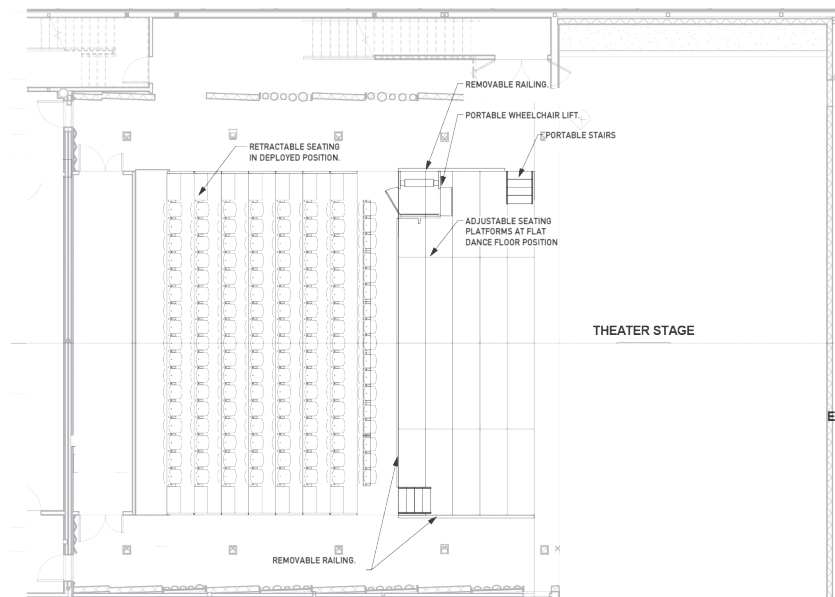

## details

- Retractable seating platform fully extended (180 seats)
- Orchestra pit dropped down into lowest position for dance floor or orchestra use, 676 sq. ft. (max. standing room = 130)
- Includes 28 moveable seats in the side balconies
- Seating capacity decreases with wheelchair tickets sold (inquire for more information)

**best uses** Performance feat. full orchestra  
Concert or performance with dance floor



# cabaret layout: 213

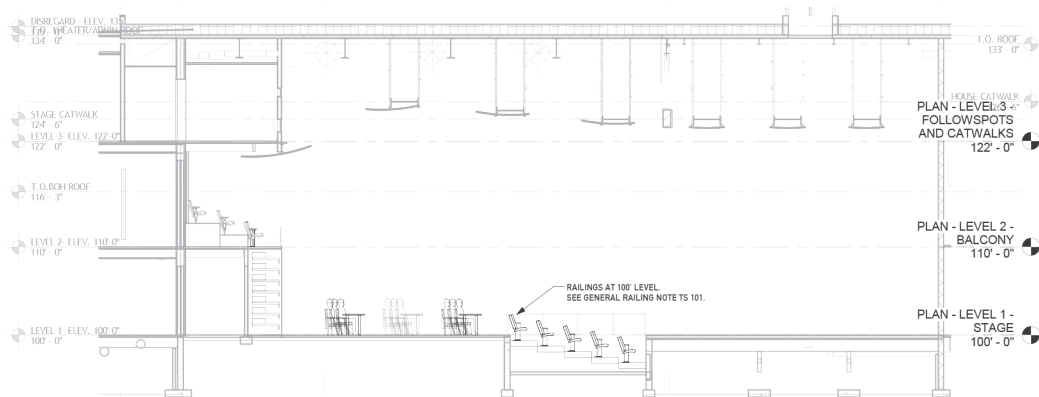
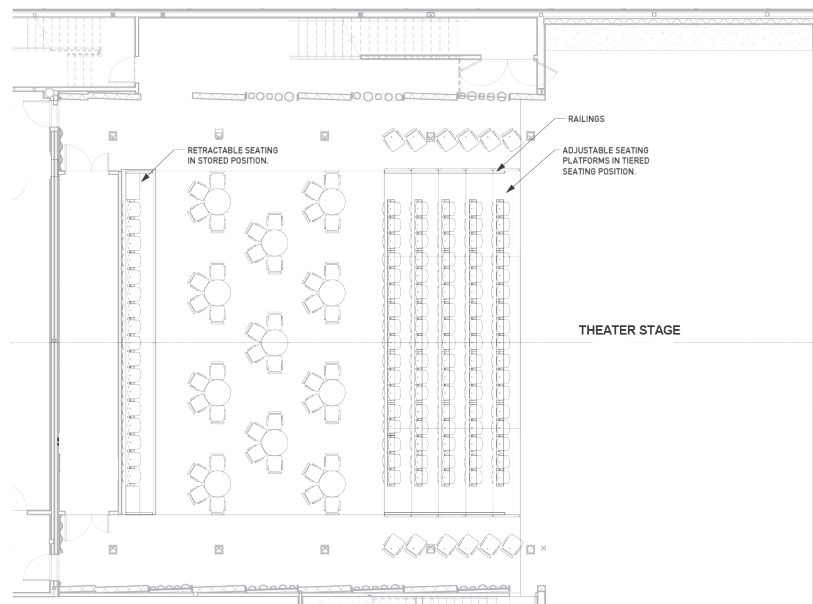

## details

- Retractable seating platform retracted; 11 cabaret tables (36") with seating for 44
- Raked orchestra seating for 85
- Includes 28 moveable seats in the side balconies and 12 moveable seats on the orchestra sides
- Center balcony fixed seats for 44
- Seating capacity decreases with wheelchair tickets sold (inquire for more information)

**best uses** Cabaret-style performances  
Fundraisers with VIP cabaret seating

banquet: 200 | flat floor standing room: 350

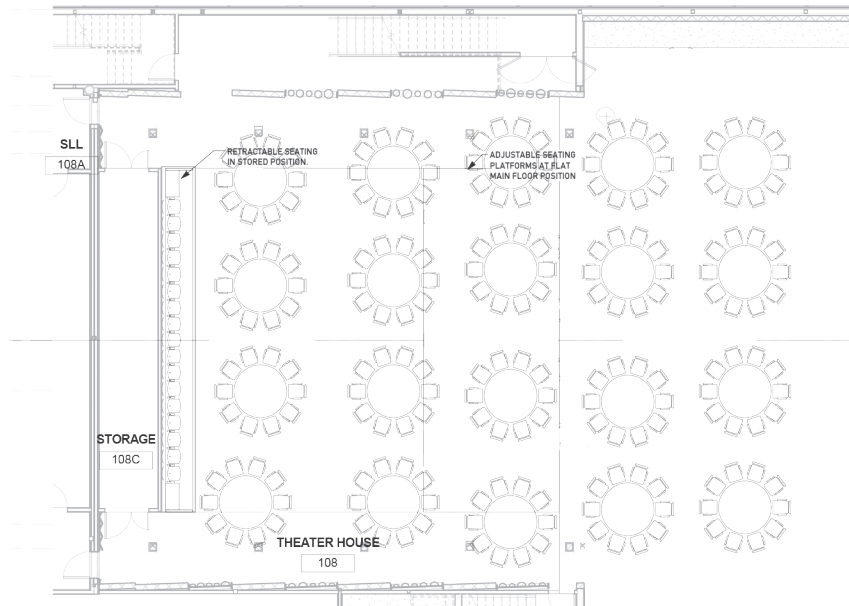

#### details

- Retractable seating platform fully retracted
- Orchestra pit in flat, floor-level position
- Seating at 5' round tables for up to 200 guests
- Includes 28 moveable seats in the side balconies and 44 fixed seats in the center balcony
- For standing-room performance, renter will need to bring in a raised platform for performers

**best uses** Gala or wedding reception  
Rock and roll concert



banquet seating, as shown, for 160





# furnishings + staffing

## chairs + tables

- 300 mahogany resin folding chairs with black seat pads
- 18 black plastic artist's stools with backs
- 12 black wooden stools (no backs)
- 40 padded theatre chairs with green fabric seats, maple backs, and black metal arms
- 20- 8' rectangular banquet tables
- 12- 60" round tables
- 16- 72" round tables
- 10- 24" cocktail tables (30" height or 42" height)
- 2- 30" cocktail tables (42" height)
- 5- 6' art tables
- 1- 6' wooden art demonstration table with mirror
- 1- wooden podium



Chairs and tables in the Center's inventory are available for use with your space rental. Renters are responsible for any tables or chairs needed in addition to these.

## linens

The Center owns 20 basic black linens for 8' banquet tables. These are available for use with your space rental. Any other linens you need are the renter's responsibility.

## technical + theatre staffing

### private or for-profit | nonprofit

- |                       |           |           |
|-----------------------|-----------|-----------|
| • Technical Director: | \$55/hour | \$48/hour |
| • Assistant TD:       | \$48      | \$40      |
| • Stage Manager:      | \$48      | \$40      |
| • Rigger/Focus:       | \$48      | \$40      |
| • Light Board Op:     | \$40      | \$35      |
| • Sound Board Op:     | \$40      | \$35      |
| • Spot Op:            | \$40      | \$35      |
| • Projectionist:      | \$40      | \$35      |
| • Run Crew:           | \$30      | \$25      |
- Lighting Designer: available at prevailing cost, depending on show needs
  - Sound Designer: available at prevailing cost, depending on show needs

## front of house staffing

### private or for-profit | nonprofit

- |                     |           |           |
|---------------------|-----------|-----------|
| • Bartender*:       | \$30/hour | \$25/hour |
| • Box Office Staff: | \$30      | \$25      |
| • Coat Check*:      | \$30      | \$25      |
| • Usher*:           | \$30      | \$25      |
| • Security Lead:    | \$80      | \$65      |
| • Security Staff**: | \$30      | \$25      |
| • FOH Manager:      | \$40      | \$35      |

*All hourly rates will be billed at a minimum of 3 hours.*

*\* one staff member per 50 guests*

*\*\* one staff member per 75 guests, depending on the type of event*



# technical equipment

## steddy theater

### Front of House

- PA Left/Center/Right is capable of undistorted 110 dB/spl
- D&BY series (5s/8s) speakers Main Array
  - 2Left, 2Right, 2Center
- D&B Yi-series subs
- D&B E-series delay/underhang areas
- Midas M32 @ FOH, House Left Center second floor
- iPad and wireless router

### Monitor

- Midas M32 @ stage
- Midas DL32
- Electro-Voice Elx 112P (8)

### Power

- Dedicated A/V power SL, SR, DS
- Distro power available for a power supply
- Dedicated lighting power SL, SR, DS

## house equipment list

### Consoles

- Midas M32 @ FOH
- Midas M32 @ Stage

### Monitors

- Electro-Voice Elx112P(8)
- MackieSRM450(4)

### Projector

- Panasonic PT-RQ32K 27,000 lm (Center) 4K+ (5120 x 3200), 3 DLP Laser Projector

### Miscellaneous

- LR Baggs (1)
- Radial J48 Active Direct Box (2)
- Radial JDI Passive Direct Box (2)
- Radial JDI Stereo Passive
- Direct Box (2)
- Variety of Stands
- 5 Guitar Boat (1)
- Single Guitar Stands (2)
- Variety of XLR 10', 20', and 50'
- Furman Power Drops (6)

### Microphones

- AKG D 112 (1)
- Audio-Technica AT 4033a (1)
- Beyerdynamic M88 (2)
- DPA 4288 Directional Headset (2)
- EV ND44 (4)
- EV ND66 (2)
- EV ND68 (1)
- Sennheiser 604 (4)
- Sennheiser E906 (4)
- Sennheiser MD421 (2)
- Shure Beta 52 A (2)
- Shure Beta 57 A (2)
- Shure Beta 58 (1)
- Shure Beta 58 Wireless (3)
- Shure Beta 98 A (2)
- Shure KSM 137 (4)
- Shure KSM 8 (2)
- Shure KSM 9 Wireless (2)
- Shure SM 57 (7)
- Shure SM 58 (10)
- Shure SM 81 (4)
- Shure SM 91 (3)
- Shure SM 99 SE (1)
- Shure VP 88 (1)
- Telefunken M80 (4)

### Lighting

- Ion ETC/EOS @ Lighting Booth
- Altman CYC
- ColorSource Pars
- ETC Luster+
- SourceFour
- Chauvet Intimidator LED Spot 350
- Follow Spot
- Hurricane 1800 Hazer

*Theater lighting plot available upon request.*

*Use of Center-owned technical equipment may be subject to additional fees, and must be operated by the Center's technical staff. Please inquire for rates.*





# basic a | v equipment

Unless otherwise noted, use of basic a/v equipment and WiFi is included with your rental, provided that you are self-sufficient and do not require technical support or staffing.

## classrooms

### King Community Room

- 75" flatscreen TV with sound bar; direct HDMI input
- Speakers throughout the room; direct aux input

### Hawk Visual Art Classroom

- 48" flatscreen TV; direct HDMI input

### Jones Performance Hall

- 48" flatscreen TV; direct HDMI input
- Audio system with aux input
- Stage lighting grid\*

### Schaul Children's Music Room

- 48" flatscreen TV; direct HDMI input
- Audio system with aux input
- Stage lighting grid\*
- Clear-com BOH paging system

*\* use of stage lighting grid requires use of theatre lighting equipment and technical staff*

## gallery

- Speakers throughout the room; direct aux input

## outside spaces

At this time, the Center's outside spaces (Feldberg East Courtyard, Feldberg West Courtyard/Patio, and Comiskey Family Terrace) do not have built-in a/v features. Use of a/v in these spaces will require bringing in equipment (either your own at no additional charge, or renting equipment from the Center and hiring Center technical staff).

Additionally, amplified sound is limited in outdoor spaces. Only recorded music, acoustic live music (no amps or singing into a mic), or speaking via microphone at a reasonable level (50 dB) are allowed. Any amplified sound in the West Courtyard or Terrace must end by 10:00 pm; 8:00 pm in the East Courtyard.

## lobbies

### grace atrium

- Audio system with aux input
- Lobby paging mic
- 48" flatscreen TVs (2) - digital signage, bar menu, Steddy Theater live feed, or your content\*\*
- "Jumbotron" video wall\*\*

### miller upper lobby

- Audio system with aux input
- Lobby paging mic
- 48" flatscreen TV - digital signage, bar menu, Steddy Theater live feed, or your content\*\*\*

*\*\* use of lobby TVs or jumbotron requires technical staff*

## back-of-house

### dressing rooms

- 24" flatscreen TV - Steddy Theater live feed
- Clear-com BOH paging system

### green room

- 48" flatscreen TV - Steddy Theater live feed
- Clear-com BOH paging system

## dance equipment

- Forever Marley sprung flooring and 8'tall mirrors in the Schaul Children's Music Room and Jones Performance Hall
- 28' wall barre in the Jones Performance Hall
- 4- 5' portable barres (wood finish, 2 levels)
- Marley floor for main stage
- Sprung floor on main stage and main house areas with mesquite wood finish
- Aerial rigging points in the Jones Performance Hall (6) and Grace Atrium (2) \*\*\*

*\*\*\* use of aerial rigging points requires install and deinstall by Center rigging staff; the Center does not provide aerial equipment beyond the rigging points. Please inquire for more information.*



# 2021 rental rates

## definitions

**peak season** June 20 - September 30  
December 15 - March 30

**off-season** April 1 - June 19  
October 1 - December 14



**low-impact** No staff set-up needed, no technical staffing required

**Example:** meetings, classes

**mid-impact** Some staff set-up needed, some technical staffing required

**Example:** receptions, cocktail parties, film screenings, acoustic concerts

**high-impact** Complex set-up required, multiple technical needs

**Example:** weddings, performances, concerts, gala fundraisers, rehearsal dinners

**classrooms**  
King Community Room  
Hawk Visual Art Classroom  
Jones Performance Hall  
Schaul Children's Music Room

## low-impact year-round

		hourly		half day, up to 4 hours (15% off hourly)		full day, 10+ hours (20% off hourly)	
room	capacity	for profit	nonprofit	for profit	nonprofit	for profit	nonprofit
Classrooms	34-53	\$50	\$25	\$170	\$85	\$400	\$200
Theater Stage/ Outdoor Stage ("rehearsal rate")	100-1000	\$75	\$40	\$255	\$135	\$600	\$300
Grace Atrium	319	\$75	\$40	\$255	\$135	\$600	\$320
Miller Upper Lobby	159	\$60	\$30	\$204	\$100	\$480	\$240
Steddy Theater, BOH, + Lobbies	350	\$200	\$100	\$680	\$340	\$1,600	\$800
Steddy Theater +BOH	350	\$150	\$75	\$510	\$255	\$1,200	\$600
Terrace + Community Room	49	\$100	\$50	\$340	\$170	\$800	\$400



## mid-impact, off-season

		hourly		half day, up to 4 hours (15% off hourly)		full day, 10+ hours (20% off hourly)	
room	capacity	for profit	nonprofit	for profit	nonprofit	for profit	nonprofit
Classrooms	34-53	\$75	\$40	\$255	\$135	\$600	\$320
Theater Stage/ Outdoor Stage ("rehearsal rate")	100-1000	\$100	\$50	\$340	\$170	\$800	\$400
Grace Atrium	319	\$115	\$60	\$390	\$205	\$920	\$480
Miller Upper Lobby	159	\$90	\$45	\$305	\$150	\$720	\$360
Steddy Theater, BOH, + Lobbies	350	\$300	\$150	\$1,020	\$510	\$2,400	\$1,200
Steddy Theater +BOH	350	\$225	\$120	\$765	\$405	\$1,800	\$960
Terrace + Community Room	49	\$150	\$75	\$510	\$255	\$1,200	\$600

## mid-impact, peak season

		hourly		half day, up to 4 hours (15% off hourly)		full day, 10+ hours (20% off hourly)	
room	capacity	for profit	nonprofit	for profit	nonprofit	for profit	nonprofit
Classrooms	34-53	\$100	\$50	\$340	\$170	\$800	\$400
Theater Stage/ Outdoor Stage ("rehearsal rate")	100-1000	\$125	\$65	\$425	\$220	\$1,000	\$520
Grace Atrium	319	\$150	\$75	\$510	\$255	\$1,200	\$600
Miller Upper Lobby	159	\$115	\$60	\$390	\$205	\$920	\$480
Steddy Theater, BOH, + Lobbies	350	\$375	\$190	\$1,275	\$645	\$3,000	\$1,520
Steddy Theater +BOH	350	\$275	\$140	\$935	\$475	\$2,200	\$1,120
Terrace + Community Room	49	\$190	\$95	\$645	\$325	\$1,520	\$760

## high-impact, off-season

		half day, up to 4 hours		full day, up to 10+ hours	
room	capacity	for profit	nonprofit (50%)	for profit	nonprofit (50%)
Classrooms	34-53	\$340	\$170	\$800	\$400
Theater Stage/ Outdoor Stage ("rehearsal rate")	100-1000	\$425	\$220	\$1,000	\$520
Grace Atrium	319	\$510	\$255	\$1,200	\$600
Miller Upper Lobby	159	\$390	\$205	\$920	\$480
Steddy Theater, BOH, + Lobbies	350	\$1,275	\$645	\$3,000	\$1,520
Steddy Theater +BOH	350	\$935	\$475	\$2,200	\$1,120
Terrace + Community Room	49	\$645	\$325	\$1,520	\$760

## high-impact, peak season

		half day, up to 4 hours		full day, up to 10+ hours	
room	capacity	for profit	nonprofit (50%)	for profit	nonprofit (50%)
Classrooms	34-53	\$425	\$215	\$1,000	\$520
Theater Stage/ Outdoor Stage ("rehearsal rate")	100-1000	\$510	\$255	\$1,200	\$600
Grace Atrium	319	\$645	\$325	\$1,520	\$760
Miller Upper Lobby	159	\$510	\$255	\$1,200	\$600
Steddy Theater, BOH, + Lobbies	350	\$1,615	\$800	\$3,800	\$1,880
Steddy Theater +BOH	350	\$1,190	\$595	\$2,800	\$1,400
Terrace + Community Room	49	\$850	\$425	\$2,000	\$1,000

*By definition, high-impact events last at least 4 hours, and so the Center does not offer an hourly rate for these types of events.*





# bar information

## policies

Per state and county regulations, service and consumption of alcoholic beverages at the Center is only permitted through the Center's on-premise liquor license.

The Center offers multiple, fully customizable options for alcohol service for rental events, including a cash bar option, a hosted bar, and all-inclusive, price-per-head packages.

For hosted or partially hosted bars, a service fee of 20% and Town of Crested Butte sales tax of 9.4% will be added to your final invoice.

Bar minimums are required for all bar options, with a \$150 sales minimum per hour required for all hours of bar service. Groups of 50 or fewer will be subject to a decreased minimum of \$325 in sales for four hours.



## pricing options

### cash bar

Attendees or guests purchase drinks individually.

### hosted bar

The host pays for guest beverages.

### per-head pricing

The Center's per-head, all-inclusive bar pricing does not require a bar minimum. Alcohol pricing will apply to all attendees over 21 years of age, regardless of consumption.

### partially hosted bar

- Some groups may wish to offer a **partially hosted** bar, limiting the amount that the host pays for guest beverages to either a maximum dollar amount or an allotted amount of time. The bar can transition to a cash bar for the remainder of the event, or close.
- Or, groups may offer a partially hosted bar via **drink tickets**, where guests are given a certain number of tickets redeemable for hosted beverages, and any additional beverages are available for purchase.
- Groups may also offer guests a **limited menu** of hosted beverages (eg beer and wine hosted, cocktails available for purchase).

## ordering

Your menu choices are due no later than 4 weeks before your event. For hosted bars, a deposit of 50% of the anticipated total invoice is due at the same time.

Groups may request items that are not on the menu and the Center will do our best to source your requests. If the item is not something the Center usually serves, you will be responsible for purchasing the *full case or keg* at per bottle/per keg retail cost. Per state and local liquor laws, alcoholic beverages may not be removed from the Center and all unconsumed special order alcohol must remain at the Center following your event.



# bar menu

## wine

**house**      **\$7 glass | \$27 bottle**

Scarpetta, Frico Frizzante Prosecco

MAN Family Wines Sauvignon Blanc  
La Fiera Delle Venezia Pinot Grigio  
Butterfield Station Chardonnay  
Mont Gravet Rosé

Hahn Pinot Noir  
Flat Rock Cabernet Sauvignon

---

**tier 2**      **\$10 glass | \$38 bottle**

Riondo Prosecco

Decoy Sauvignon Blanc  
Fantaniel Pinot Grigio  
Bernier Chardonnay  
Elk Cove Rosé

Angeline Pinot Noir  
Charles + Charles Red Blend  
Liberty School Cabernet Sauvignon

**tier 3**      **\$14 glass | \$45 bottle**

La Marca Prosecco

Dog Point Sauvignon Blanc  
Villa Alpini Pinot Grigio  
Joel Gott Chardonnay  
Chateau Gassier Rosé

Starmont Pinot Noir  
Alexander Valley Vineyards, Homestead Red Blend  
Château Smith Cabernet Sauvignon

---

**sparkling wine toasts**      **\$3 per guest**

Pricing for Riondo Prosecco; higher-tiered or custom sparkling wine or champagne will be subject to additional charges.

## beer

**domestic**      **\$3 can**

Rolling Rock

**house**      **\$6 pint | \$190 pony keg  
\$350 half barrel keg**

Irwin Brewing Teocalli Mexican Lager  
Irwin Brewing Local Pride Premium Pilsner

Oskar Blues Dale's Pale Ale  
Odell Brewing IPA

Avery Brewing Ellie's Brown Ale  
Irwin Brewing Nitro Stout

## liquor

**house**      **\$7 single | \$12 double**

Svedka Vodka | Tanqueray Gin | Hornitos Tequila  
Montanya Oro + Platino Rums  
Jack Daniels Whiskey | Jim Beam Bourbon

**tier 2**      **\$9 single | \$14 double**

Tito's Vodka | El Jimador Silver Tequila  
Jameson Irish Whiskey | Bulleit Rye Bourbon  
Woodford Reserve | Johnnie Walker Black Label

---

*Listed prices do not include tax or service fees. Menu items and prices are subject to change at any time.*



# bar menu

## cocktails

examples of cocktails available | \$12

### old fashioned

Bulleit rye bourbon, cane sugar syrup, Angostura bitters, orange peel garnish, topped off with hickory wood smoke

### bee's knees

Tanqueray gin, fresh lemon + house-made honey syrup

### fresh margarita

Silver tequila, agave, fresh squeezed lime and orange juice, *optional jalapeño*

### mountain mojito

Montanya platino rum, muddled mint, fresh lime juice, agave, topped with soda water

Have a special cocktail in mind that you'd like to see on the menu? Just ask! Our bar staff is happy to create something custom just for you.

---

## non-alcoholic

Coke | Diet Coke | Sprite | Ginger Ale  
Soda | Tonic  
**\$2 each**

Red Bull | Sugar-Free Red Bull  
Topo Chico | Ginger Beer  
**\$3 each**

For parties of fifty or more with a hosted bar, select non-alcoholic beverages from the menu are provided at no additional cost for all guests. For parties of fewer than fifty, non-alcoholic beverages are available to be hosted or purchased by guests on consumption, or for a flat, hosted fee of \$2 per guest for unlimited non-alcoholic beverages.

---

## per-head pricing

		4 hours	5 hours
<b>basic bar</b>	Domestic + House Beer House Wine Soft Drinks + Juice	\$45	\$50
<b>house bar</b>	Domestic + House Beer House Wine House Liquor Soft Drinks + Juice	\$55	\$60
<b>premium bar</b>	Domestic + House Beer Tier 2 Wine Tier 2 Liquor Soft Drinks + Juice	\$65	\$70

Per-head pricing is not negotiable and does not include tax, gratuity, champagne toasts, shots, neats, martinis, or doubles. Bartender(s) and a basic bar set-up with glassware are included. A gratuity and service fee of 20%, and Town of Crested Butte sales tax of 9.4% will apply. For parties of fifty people or more, select soft drinks and non-alcoholic beverages will be available at no additional cost for all guests. Prices and menu items are subject to change at any time.





# coronavirus policies

The Center is currently open for events during the coronavirus pandemic and operating at a reduced level, in compliance with Gunnison County and Colorado state public health orders and mandates on gathering restrictions. We are in close communication with County Public Health Officials to determine any changes that need to be made to our pandemic operating plan.

The Center's HVAC system is extremely efficient and brings in outside air and circulates it frequently through rooms in our building; we also have multiple outdoor spaces available to rent for larger, socially distanced gatherings. We have strict sanitization and safety policies in place, including:

- A county-approved division of our 31,000 square foot, three-story building into "zones" to allow multiple small events to occur simultaneously, ensuring that groups will never cross paths.
- Mandatory mask-wearing is enforced when in the Center building, except while stationary and actively eating and drinking, or except in fitness classes after students have arrived in their distanced "spot."
- Strict and frequent sanitization of frequently touched surfaces before, during, and after events.
- Social distancing enforced ("pods" of those in the same household may gather closely)

We are accepting bookings through 2022. A 50% deposit of your rental fee is required to reserve your date. For the duration of the pandemic going forward, the Center is operating under the following covid cancellation policy: If at least thirty (30) days prior to the event, the renter decides, in their reasonable judgment, that going forward with the event is substantially impractical and/or impossible due to the ongoing COVID-19 pandemic, the renter may the event upon notice to the Center. Upon such cancellation, the Center will refund your initial deposit.

Please inquire for the most up-to-date gathering numbers and other restrictions. Our staff is happy to help you plan a safe event!





# get in touch

---

During the coronavirus pandemic, the Center is operating with a reduced staff. We are grateful for your patience and understanding!

**melissa mason**

**associate director**

970.349.7487

[melissa@crestedbuttearts.org](mailto:melissa@crestedbuttearts.org)

**photo credits:**

james ray spahn  
nathan bilow  
andrew tower  
choate house  
third eye photography

